

Cleveland State University 4th Annual Regional Chemistry Symposium March 12 and 13, 2015

Location

The 4th Annual Regional Chemistry Symposium will be held at Cleveland State University, Student Center Building, 2121 Euclid Avenue, Cleveland, Ohio 44115 (corner of Euclid and East 22nd Street).

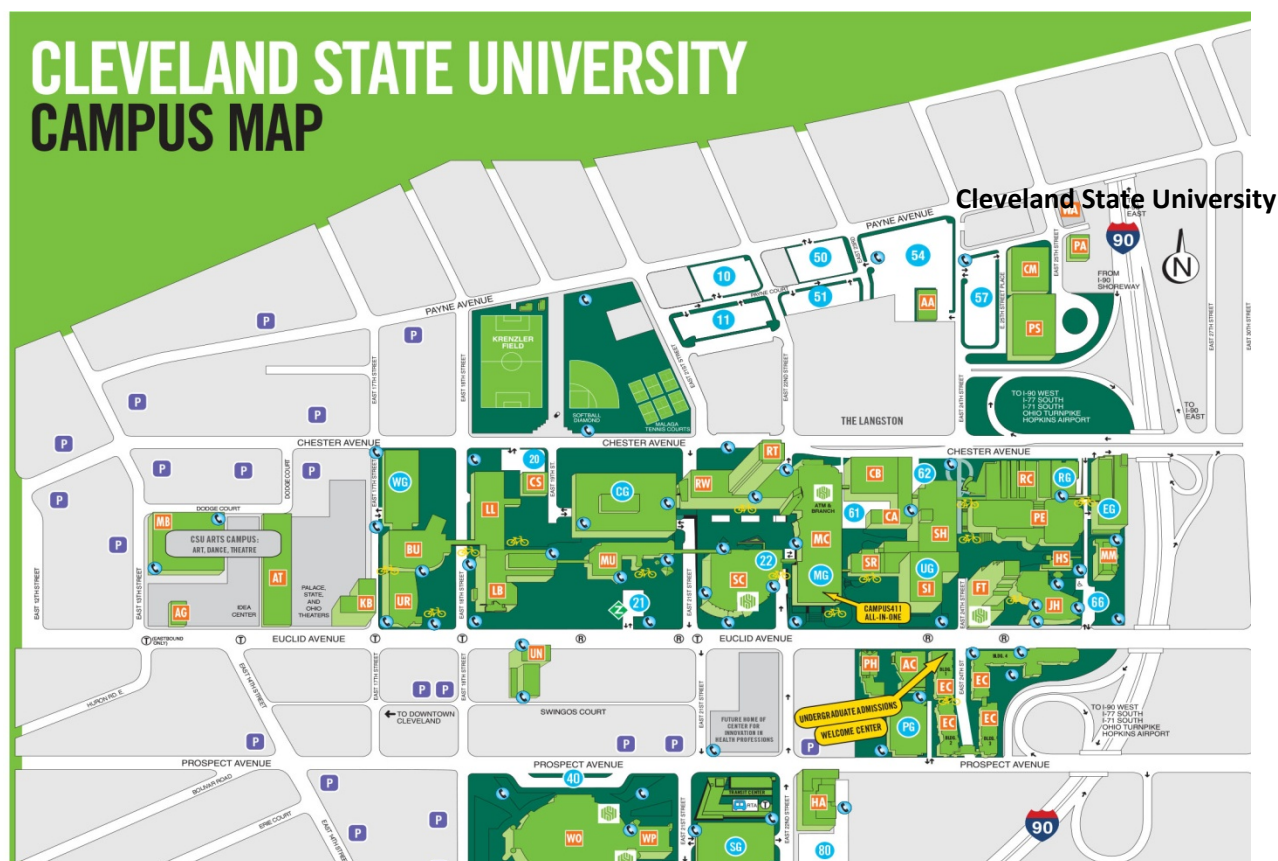

Directions and Parking

Parking for this conference is available under the Student Center (SC, number 22 on the map) located between East 21st and East 22nd Streets between Euclid and Chester Avenues. East 21st Street is one way (south bound) and East 22nd Street is one way (north bound). Additional parking information will be available in the future.

Link to [CSU Campus Map](#)

[Driving Directions to CSU](#)

Overnight Accommodations

Wyndham Cleveland at Playhouse Square
1260 Euclid Avenue, Cleveland Ohio 44115
visit [The Wyndham](#)

The Wyndham Hotel, located at Playhouse Square in downtown Cleveland, is allowing affordable discount rates for attendees of the symposium. Transportation to CSU is available at the hotel—it is also a 4-minute walk to CSU.

Deadline for limited special hotel rates: February 28th, 5 PM

For reservations, call Linda Karcher at Wyndham on Playhouse Square,: 216-615-3322

Conference events

Details about the symposium can be found at the EngagedScholarship@CSU Regional Chemistry Symposium website at <http://engagedscholarship.csuohio.edu/csurcts/>

Airport

Cleveland International Airport (CLE) is located 12 miles from downtown Cleveland

They have direct rail service, with Regional Transit Authority [RTA](#)'s Red Line Rapid offering a short commute to downtown to [Tower City](#), on Public Square: 230 W Huron Road, Cleveland. Taxis are also available.

Public Transportation

RTA provides numerous transportation options around the city, including the Healthline, Downtown Bus/Rapid, and the Free Trolley. Maps and schedules can be found [here](#).

Dining and Local Attractions

Many [restaurants](#), both casual and upscale, are within walking distance of Cleveland State University and are convenient to the Chemistry Symposium attendees.

For those wishing to spend extra time in Cleveland, and to find out what our city has to offer, the following links provide information for dining and sightseeing.

Tremont Dining

<http://www.urbanspoon.com/n/16/1543/Cleveland/Tremont-restaurants>

Ohio City Dining

http://www.ohiocity.org/index.php?option=com_content&view=article&id=106&itemid=229

The Warehouse District

<http://www.warehousedistrict.org/visit.aspx>

Sightseeing

The [Rock and Roll Hall of Fame and Museum](#)

Great Lakes Science Center

<http://www.glsc.org/>

Playhouse Square

<http://www.playhousesquare.org/>

Going out in Cleveland

<http://www.cleveland.com/goingout/>

Museums

Museum of Art

<http://www.clevelandart.org/>

Museum of Contemporary Art

<http://www.mocacleveland.org/>

Cleveland Museum of Natural History

<http://cmnh.org/site/Index.aspx>

Cleveland's [University Circle](#) boasts a concentration of arts and cultural institutions, all within 1 square mile.

More dining and entertainment can be found at [East 4th street Entertainment District](#)

For more information about Cleveland, visit [This is Cleveland](#).

General Chemistry Symposium 2012

Download our [2012 newsletter](#).

For more information about the 4th Annual Regional Chemistry Symposium, contact Dr. Jerry Mundell at j.mundell@csuohio.edu



LOCATION

The centerpiece of Cleveland's Theater and Business Districts, the Wyndham Cleveland Hotel at PlayhouseSquare is just steps away from numerous popular area attractions. With luxuriously appointed guest rooms and two levels of meeting space, the **Wyndham Cleveland is sure to make you feel like the star of the show!**

FEATURES

- 205 spacious guest rooms with 1 Presidential Suite
- 34 guest room suites
- 24-hour business center with wireless remote printer
- Indoor lap pool, whirlpool and sauna
- Fully equipped fitness center
- Dry cleaning and in-house laundry services
- Valet parking service
- Wyndham Rewards
- Social events and Weddings from 25 to 300 guests
- On-site wedding specialist
- Custom wedding packages
- Group discounted rates
- Conveniently located near local attractions
- Located in the center of the Euclid Corridor Transit Line
- 15 minutes from Cleveland Hopkins International Airport

ROOM DETAILS

- Brand New Bedding Package - Luxurious Englander Ventura Pillow Top Mattresses, 3" Gel Top Super Soft Polyfoam, complimented with oversized pillows and 300 thread count sheets
- **50 Meg Fiber Optic Wireless Internet/Standard Package (512K) - FREE**
- HD Cable T.V. - In Room Movies
- Iron, ironing board, hairdryer
- Coffee maker
- Bath & Body Works® toiletries
- Oversized desk with Herman Miller chair
- ADA accessible rooms

DINING AND ENTERTAINMENT

- Our Encore Restaurant offers an elegant yet comfortable setting for breakfast, lunch, and dinner
- Blue Bar for cocktails
- PlayhouseSquare restaurants and theaters
- Room service
- Walking distance to local restaurants

ATTRACTIONS

- PlayhouseSquare Theaters
- Horseshoe Casino
- Rock & Roll Hall of Fame
- E. 4th St. Restaurant District
- Cleveland Browns Stadium
- Progressive Field - Home of the Cleveland Indians
- Quicken Loans Arena - Home of the Cleveland Cavaliers
- Greater Cleveland Aquarium

MEETING SPACE HIGHLIGHTS

- 13,200 square feet of renovated meeting space
- 5,100 square-foot ballroom
- 9 total meeting rooms with banquet seating up to 350 and receptions up to 550
- Complete banquet and catering services with trained staff
- State-of-the-art audiovisual equipment onsite
- Spectacular outdoor terrace overlooking PlayhouseSquare for corporate or social events.
- Executive Boardroom
- Spacious prefunction areas
- **50 Meg Fiber Optic Wireless Internet / Standard Package (512K) - FREE**
- Executive Chef available to create personalized group menus.

AWARDS

- 2013 TripAdvisor Certificate of Excellence Winner
- Connector's Choice Award Winner for Best Corporate Meeting Venue 4 years running 2010-2013

GETTING THERE

From Cleveland Hopkins International Airport (CLE) Distance : 12 miles. From airport, take highway 71 North (which turns into 90 East) to the East 9th Street exit #172A. Take East 9th St. to Euclid Ave. and turn right. The Wyndham will be two blocks down on the right.



MEETING SPACE CAPACITY CHART

Name Of Room	Dimensions	Square Feet	Ceiling Height	Reception	Banquet	Theater	Classroom	Hollow Square	U-shape	Conference
Level Two										
Palace Ballroom	44' x 116'	5,112	15'	550	350	530	250	84	--	--
Palace East	44' x 54'	2,409	15'	250	140	230	100	50	45	--
Palace West	44' x 61'	2,703	15'	300	160	270	150	55	50	--
Stillman	31' x 33'	1,073	11'	75	60	90	45	26	22	28
Pre-function	--	1,600	11'	230	--	--	--	--	--	--
Level Three										
State	44' x 26'	1,144	11'	100	80	105	60	36	35	25
Allen	27' x 26'	702	11'	45	40	65	35	22	20	15
Hippodrome	17' x 26'	442	11'	--	--	--	--	--	--	10
Boardroom	--	615	11'	40	30	55	20	22	20	15
Hanna	--	615	11'	40	30	55	20	22	20	15
Roxy	36' x 16'	576	11'	50	40	55	30	26	20	15
Embassy	--	1,200	--	80	60	--	--	--	--	--

*Figures have NO stages, additional tables/seating, A/V equipment, podiums, etc.

FLOOR PLAN CHART

Level Two

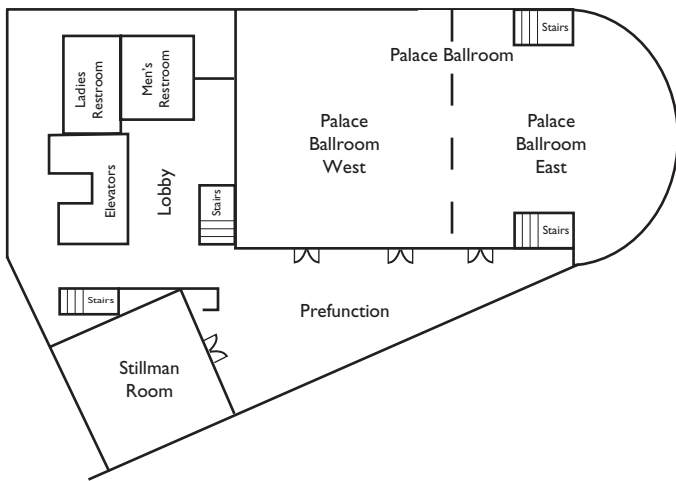

Level Three

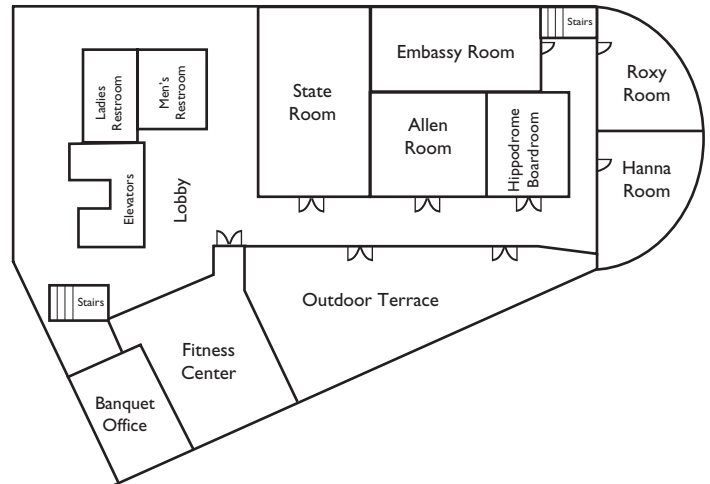

1260 Euclid Avenue, Cleveland, Ohio 44115 Phone: 216-615-7500 Fax: 216-621-8659

800-WYNDHAM / wyndhamcleveland.com